

THE WEEK OF SEPT. 29TH, 2019



St. Michael and all Angels



WELCOME TO HOPE!

We extend a warm welcome to our visitors and ask you to sign the red "Friendship Register" in your pew. We are glad that you are here to worship with us and encourage you to become a part of our fellowship.

Nursery is available for young children during both worship services and also during the Adult Bible Study hour (7:45am-11:45am)

Please ask an usher for directions to the classroom.

HOPE LUTHERAN CHURCH

2600 Haines Rd. Levittown PA 19055

The Rev. Dr. Rich Mokry, Pastor RMokry@hopeLCS.org

Office: 215-946-3467

info@hopelcs.org

www.hopelcs.org



Communion

We believe that in, with, and under the bread and wine Christ gives to us His body and blood for the forgiveness of sin. St. Paul reminds us that we ought to examine ourselves and make peace with one another lest we take God's judgment upon ourselves. Those who are united with us in these beliefs are welcome to commune.



The LUTHERAN HOUR in Lower Bucks County airs Sunday mornings at 7am on 89.3 (Warminster), 97.1 (Bensalem), 107.3 (Phila.), 91.7 (Levittown)

ALSO: on 91.9 (Lawrenceville, NJ) at 12 p.m. (Sunday noon) and 6 p.m. (Tuesdays).

Next Sunday, Speaker: Dr. Rev. Michael Zeigler "Homeward"

Speaker: Communing with God—Lord's Prayer 1 Corinthians 11:17-34

To access The Lutheran Hour: www.lutheranhour.org

To access the Daily Devotions: www.lhm.org/dailydevotions



Sunday Attendance 8:00 am 10:30 am

Missed a Sunday? Sermons are on Hope's website.

www.hopeLCS.org -> click Church -> click Worship -> click Sermons

Bulletin Announcements on Hope's website:

www.hopeLCS.org -> click Church -> click News

Heartfelt Giving on Hope's website: www.hopeLCS.org -> click Church -> click Giving in the top blue banner -> click Giving by Shopping

SIMPLY GIVING PROGRAM by THRIVENT

Information available in the narthex. Questions?

Contact Tom Marks 215-757-1702 or Kristina Hoffman 215-946-3467



Family Promise at Hope

Are you interested in helping homeless families with children in our area? We are seeking individuals to assist in our Outreach program to assist in helping our friends in need. If you would like to learn more or would like to be involved in some, little way.. Simply mark "Family Promise" in your Fellowship Registration and someone will contact you...

~"Carry each other's burdens, and in this way you will fulfill the law of Christ"

Galatians 6:2

Evening Bible Study every Tuesday 6:30pm

Join us as we study **1 & 2 Thessalonians and Titus**, while building/strengthening friendships with other people of faith.



Contact **Enola Cook** at 609-464-2366 **OR** by email:
rev3-20@hotmail.com

YOUTH GROUP

Youth Group Activity Night & Bible Study Gr. 5-12

Every Wednesday night from 6:30-8:30 p.m. Invite friends!
Contact: Chris Paulsen 908.917.4886 daggs5@aol.com



You are invited to join
"Stitchers of Hope"

Location: Enola Cooks' Residence
45 Gun Road Levittown PA
EVERY Saturday @ 2pm

Come out and enjoy the various stitching techniques being used ~we can teach you!

Words of Hope - Weekly Announcements

Fulfilling the Mission of Hope

This Thursday, October 3rd, at 7:00 pm...Join us for an important meeting to share information about "Fulfilling the Mission of Hope" campaign! God is stirring us up to enhance His work at Hope. We will be meeting in room 109.

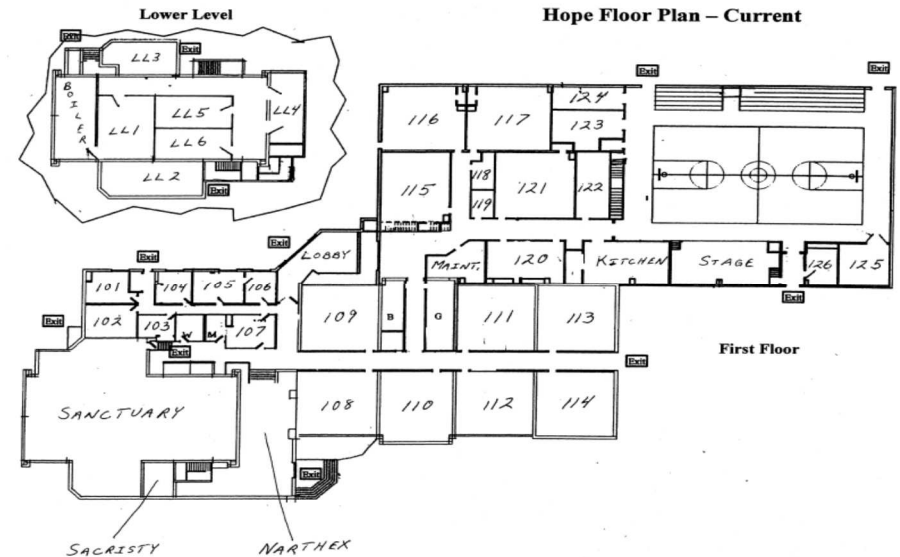

For a donation of \$5.00 to Orphan Grain Train, enjoy 25% off of unlimited purchases at Boscov's department store! How "Guilt-free" shopping should be-while helping out others in need of course!

Calling ALL Campers

Where: French Creek State Park - about 70 minutes from Hope
When: Friday, October 4 through Sunday, October 6. Stay for 1 night or 2!
 Check in/out is at 3pm.
Campground Location: Loop B sites - electric and non-electric and handicap accessible available
Cost: About **\$36.50/night**
(Go online to make your reservation as soon as possible to be sure that spots are available)
 Once you book, *please* **RSVP** with your site number to **Lauren Shockey** at:

mlshockey@yahoo.com

If you need help with your reservation or would like to go but are in need of camping equipment, please call **Lauren** at **267-961-3154**.

We hope to see many of you there!



OPERATION CHRISTMAS CHILD

Hope will be collecting gift-filled shoeboxes for **Operation Christmas Child**, a project of Samaritan's Purse, the week of **November 18 - 24**. Empty shoeboxes will be available in the narthex in the fall.

Meanwhile, you may want to take advantage of bargains. Gift suggestions are: school supplies, such as pencils, pens, crayons, notebooks, etc. Also, non-liquid hygiene items, such as toothbrushes, bar soap, washcloth, etc. You can choose a boy or girl (ages 2-4, 5-9 or 10-14) to receive your shoebox.

For more gift suggestions or if you have any questions, please call Marjie Rodkey at: (215-949-1695) or Barb Somerfield (215-378-9923).

	This Week	(Next Week)
Reader—8:00 am	J. Streight	D. Fairfield
Bible Readings:	Dan. 10:10-14 Rev. 12:7-12 Luke 10:17-20	Hab. 1:1-4; 2:1-4 2 Tim. 1:1-14 Luke 17:1-10
Comm. Assistants:	T. Marks and T. Jeske	D. Fairfield and B. Warrell
Acolyte—8:00 am	none	none
Altar Guild for September:	none	none
Organist and Music Director:	Mrs. Shockey	



	This Week At Hope	
	*Full church calendar may be found on the web at www.hopeLCS.org	
Sunday	8:00 am Traditional Worship 9:15 am Sunday School /Adult Bible Study 10:30 am Contemporary Worship 11:45 am AA at Hope	Room 109 Room 102
Monday		
Tuesday	1:00 pm Woman's Bible Study 7:00 pm Bible Study- Enola Cook (609)-464-2366 7:30 pm *Hand bell	Conf. Room
Wednesday	6:30 pm Youth Group 7:30 pm Voice Choir	
Thursday	7:00 pm Celebrate Recovery	Room 102
Friday		
Saturday	2:00 pm Stitchers' of Hope	
Sunday	8:00 am Traditional Worship 9:15 am Sunday School / Adult Bible Study 10:30 am Contemporary Worship 11:45 am AA at Hope	Room 109 Room 102